

This device complies with Part 15 of the FCC Rules.

Operation is subject to the following two conditions:

- (1) This device may not cause harmful interference, and (2) this device must accept any interference received, including interference that may cause undesired operation.
- This equipment has been tested and found to comply with the limits for a Class B digital device, pursuant to Part 15 of the FCC rules. These limits are designed to provide reasonable protection against harmful interference in a residential installation. This equipment generates uses and can radiate radio frequency energy and, if not installed and used in accordance with the instructions, may cause harmful interference to radio communications. However, there is no guarantee that interference will not occur in a particular installation. If this equipment does cause harmful interference to radio or television reception, which can be determined by turning the equipment off and on, the user is encouraged to try to correct the interference by one or more of the following measures:
 - Reorient or relocate the receiving antenna.
 - Increase the separation between the equipment and receiver.
 - Connect the equipment into an outlet on a circuit different from that to which the receiver is connected.
 - Consult the dealer or an experienced radio/TV technician for help.

NOTE: Changes or modifications not expressly approved by the manufacturer responsible for compliance could void the user's authority to operate the equipment.



Protect the environment by not disposing of this product with household waste (2002/96/EC). Check your local authority for recycling advice and facilities.



CONFORMS TO THE SAFETY REQUIREMENTS OF ASTM F963.

© 2010 Mattel, Inc. All Rights Reserved.

RADICA USA Ltd. www.radicagames.com Helpline 1.800.803.9611 or service.mattel.com.

Mattel, Inc. 636 Girard Avenue, East Aurora, NY 14052, U.S.A. Consumer Relations 1-800-524-8697.

Mattel Canada Inc., Mississauga, Ontario L5R 3W2.

Mattel Europa, B.V., Gondel 1, 1186 MJ Amstelveen, Nederland.

Mattel U.K. Ltd., Vanwall Business Park, Maidenhead SL6 4UB. Helpline 01628 500303.

Mattel Australia Pty., Ltd., Richmond, Victoria. 3121. Consumer Advisory Service - 1300 135 312 Mattel East Asia Ltd., Room 1106, South Tower, World Finance Centre, Harbour City, Tsimshatsui, HK, China.

Diimport & Diedarkan Oleh: Mattel SEA Ptd Ltd. (993532-P) Lot 13.5, 13th Floor, Menara Lien Hoe, Persiaran Tropicana Golf Country Resort, 47410 PJ. Tel: 03-78803817, Fax: 03-78803867

CONSUMER INFORMATION

Need Assistance? Visit service.mattel.com or call 1.800.803.9611 (US and Canada only).

SERVICE.MATTEL.COM

Ages
6+

T8500-0920



SKULLETTE™ SENSOR MOTION ALARM INSTRUCTION MANUAL

Keep these instructions for future reference as they contain important information.

CONTENTS

1 Skullette™ Sensor Motion Alarm
(unit with attached strap)

Please remove the unit from the container. If there are any issues with the unit, please call 1-800-803-9611. Outside the U.S., please consult the listing of your local Mattel offices at the end of these instructions.

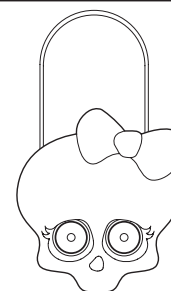

BATTERY INFORMATION

- AAA + x3 Included

- Requires 3 "AAA" Alkaline batteries. Batteries included are for demonstration purposes. Dispose of batteries safely.
- For longer life use only alkaline batteries.
- If alarm malfunctions, check the battery installation.
- BATTERIES SHOULD BE CHANGED WHEN SOUND DISTORTS OR MALFUNCTIONS.

BATTERY SAFETY INFORMATION

In exceptional circumstances batteries may leak fluids that can cause a chemical burn injury or ruin your product. To avoid battery leakage:

- Non-rechargeable batteries are not to be recharged.
- Rechargeable batteries are to be removed from the product before being charged (if designed to be removable).
- Rechargeable batteries are only to be charged under adult supervision (if designed to be removable).
- Do not mix alkaline, standard (carbon-zinc), or rechargeable (nickel-cadmium) batteries.
- Do not mix old and new batteries.
- Only batteries of the same or equivalent type as recommended are to be used.
- Batteries are to be inserted with the correct polarity.
- Exhausted batteries are to be removed from the product.
- The supply terminals are not to be short-circuited.
- Dispose of batteries safely.
- Do not dispose of this product in a fire. The batteries inside may explode or leak.

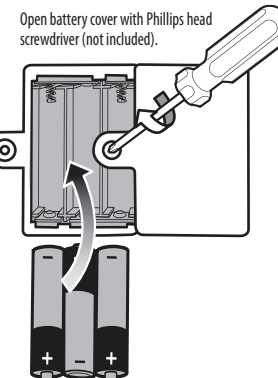

INSTRUCTION SHEET SPECIFICATIONS

Toy: SKULLETTE™ SENSOR MOTION ALARM

Toy No.: T8500

Part No.: 0920

Trim Size: 8.5" W x 8.5" H

Folded Size: 4.25" W x 4.25" H

Type of Fold: Fold into half (W & H)

colors: One

Colors: Black

Paper Stock: White Offset

Paper Weight: 70 lb.

EDM No.: 001

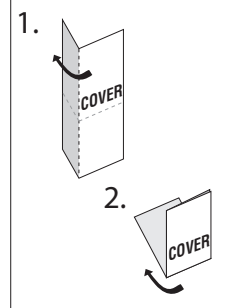

T8500-0920_Instr_v1_Dom
Date: July. 19, 2010

DETACHING THE DOOR HANGER STRAP

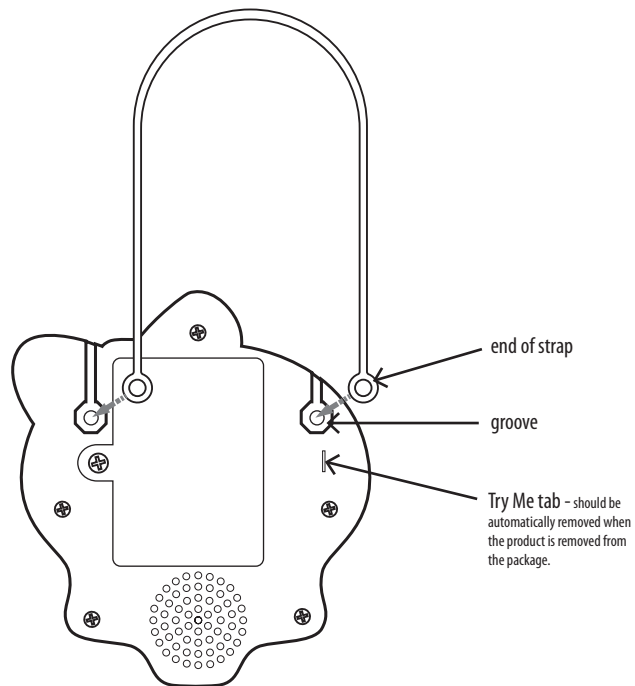

You may wish to remove the strap from your Skullette™ Sensor when you place it on top of objects (instead of hanging), or you may need to remove it in order to hang the alarm over doorknobs that are too large to slip over.

- Hold the alarm facedown.
- On the back of the alarm, you will see that each side of the strap fits snugly in a groove.
- Simply pull up on one side of the strap near its groove; it may help to use your thumb to push down on the alarm as you pull up on the strap.
- Repeat on the other side of the strap to remove completely.
- To replace the strap, just push the ends back into the grooves.

ALARMINGLY EASY TO USE!

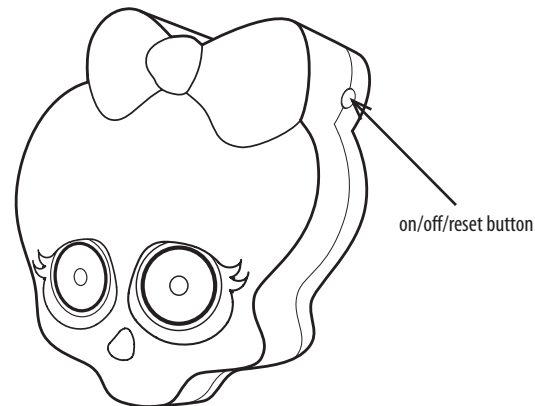

ARMING THE MOTION ALARM

- Place the Skullette™ Sensor where you want its protection, and then push the button on the right side of the bow.
- The unit will make a sound that indicates it is armed, but will wait 3 seconds to begin sensing motion (this allows extra time for the alarm to settle into its position).
- The eyes will slowly flash when it is armed and ready.

TRIGGERING THE MOTION ALARM

- Sudden movement will trigger the alarm (example: opening the door on which it hangs, or lifting it off a diary or other object).
NOTE: The motion alarm may not detect very small movements or gradual changes in position.
- When the alarm has been triggered, it will play a creepy sound effect for several seconds and the eyes will flash quickly.
- In case you are not present when the alarm is triggered, the eyes will continue to flash quickly to let you know it had been set off in your absence.
- To reset the alarm after it has been triggered, just push the button on the side of the bow.

TURNING OFF THE ALARM

- When the alarm is activated (armed), you can turn it off at any time by pressing the button on the side of the bow.

AUTO SHUT-OFF

- Whenever the alarm's eyes are slowly flashing, it is armed; if the eyes stop flashing, it has automatically shut off to conserve batteries.
- You can easily resume protection by pressing the button on the side of the bow again.

If the alarm malfunctions, please turn the unit OFF and then ON again.